

Section	T16	T15	T14	T13	T12	T11	T10	T9	T8	T7	T6	T5	T4	T3	T2	T1
Legs	SR 1 3/4															
Leg Grade	A572-50															
Diagonals	N.A.	SR 5/8														
Diagonal Grade	N.A.	A36														
Top Girts	A	SR 3/4														
Mid Girts	N.A.	SR 3/4														
Bottom Girts	N.A.	SR 3/4														
Horizontals	A	SR 3/4														
Sec. Horizontals	N.A.	SR 3/4														
Face Width (ft)	84 @ 3.20833															
# Panels @ (ft)	4 @ 3.5625															
Weight (K)	12.6	0.3	0.9	0.9	0.9	0.9	0.9	0.9	0.9	0.9	0.9	0.9	0.7	0.7	0.5	2.75

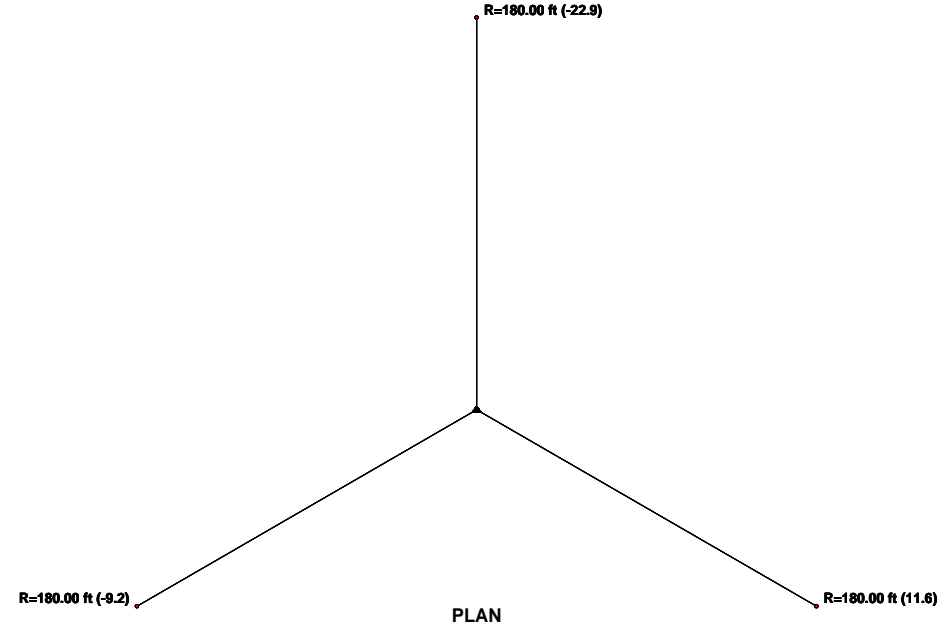
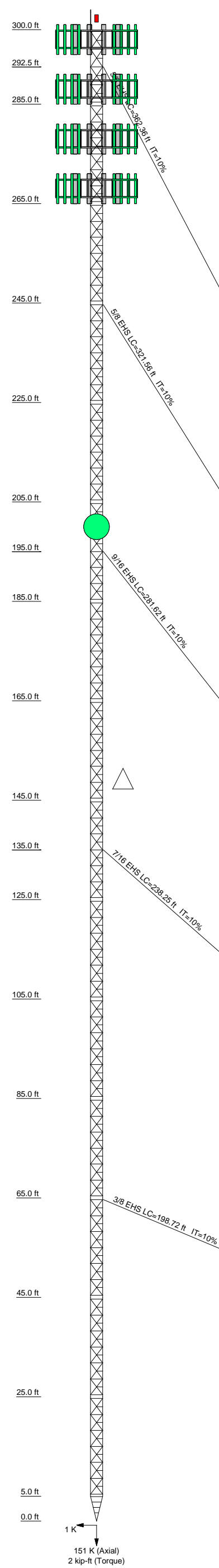

**DESIGNED APPURTENANCE LOADING**

TYPE	ELEVATION	TYPE	ELEVATION
up to 4' lightning rod	302	(4) typical 5' panels (1.625")	278
beacon lighting (opt.)	301.5	(4) typical 5' panels (1.625")	278
(4) typical 5' panels (1.625")	298	(4) typical 5' panels (1.625")	278
(4) typical 5' panels (1.625")	298	(3) 13' gate mounts	278
(4) typical 5' panels (1.625")	298	(4) typical 5' panels (1.625")	268
(3) 13' gate mounts	298	(4) typical 5' panels (1.625")	268
(4) typical 5' panels (1.625")	288	(4) typical 5' panels (1.625")	268
(4) typical 5' panels (1.625")	288	(3) 13' gate mounts	268
(4) typical 5' panels (1.625")	288	6' solid dish (1.625")	200
(3) 13' gate mounts	288	6' solid dish (1.625")	200

**SYMBOL LIST**

MARK	SIZE	MARK	SIZE
A	C6x8.2	B	5 @ 1.08333

**MATERIAL STRENGTH**

GRADE	Fy	Fu	GRADE	Fy	Fu
A572-50	50 ksi	65 ksi	A36	36 ksi	58 ksi

**TOWER DESIGN NOTES**

1. Tower is located in Tippah County, Mississippi.
2. Tower designed for a 70 mph basic wind in accordance with the TIA/EIA-222-F Standard.
3. Tower is also designed for a 61 mph basic wind with 0.50 in ice.
4. Deflections are based upon a 50 mph wind.
5. Tower designed for 3/4" integral face ladder

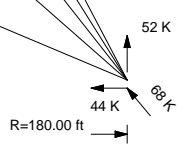

<p>Tower Innovations 2855 Hwy. 261 Newburgh, IN. 47630 Phone: (812) 853-0595 FAX: (812) 853-6652</p>	<p>Job: <b>4542 - 19181</b></p> <p>Project: <b>Dumas Tower (Tippah County), MS</b></p>	
	<p>Client: _____</p> <p>Code: TIA/EIA-222-F</p> <p>Path: C:\0 - Current Design Run\PDF01 - Typical Wireless Guyed Tower - 4542 - 19181.dwg</p>	<p>Drawn by: T.I. Engineering Dept.</p> <p>Date: 12/19/06</p>
	<p>App'd: _____</p> <p>Scale: NTS</p> <p>Dwg No. E-1</p>	
	<p>© 0 - Current Design Run\PDF01 - Typical Wireless Guyed Tower - 4542 - 19181.dwg</p>	