

Section	T1	T2	T3	T4	T5	T6	T7	T8	T9	T10	T11	T12	T13	T14	T15	T16	T17	T18	T19	T20	T21	T22	T23	T24	T25	T26	T27	T28	T29	T30	T31	T32	T33	T34	T35	T36	T37	T38	T39	T40	T41	T42	T43	T44	T45	T46	T47	T48	T49	T50	T51	T52	T53	T54	T55	T56	T57	T58	T59	T60
Legs	SR 2																																																											
Leg Grade	SR 2 3/4																																																											
Diagonals	SR 3 1/2																																																											
Diagonal Grade	SR 3 1/2																																																											
Top Girts	SR 3 1/2																																																											
Mid Girts	SR 3 1/2																																																											
Bottom Girts	SR 3 1/2																																																											
Horizontals	SR 3 1/2																																																											
Red. Horizontals	SR 3 1/2																																																											
Red. Diagonals	SR 3 1/2																																																											
Top Guy Pull-Offs	SR 3 1/2																																																											
Guy H-Diagonals	SR 3 1/2																																																											
Guy Low-Diagonals	SR 3 1/2																																																											
Face Width (ft)	SR 3 1/2																																																											
# Panels @ (ft)	SR 3 1/2																																																											
Weight (K)	SR 3 1/2																																																											

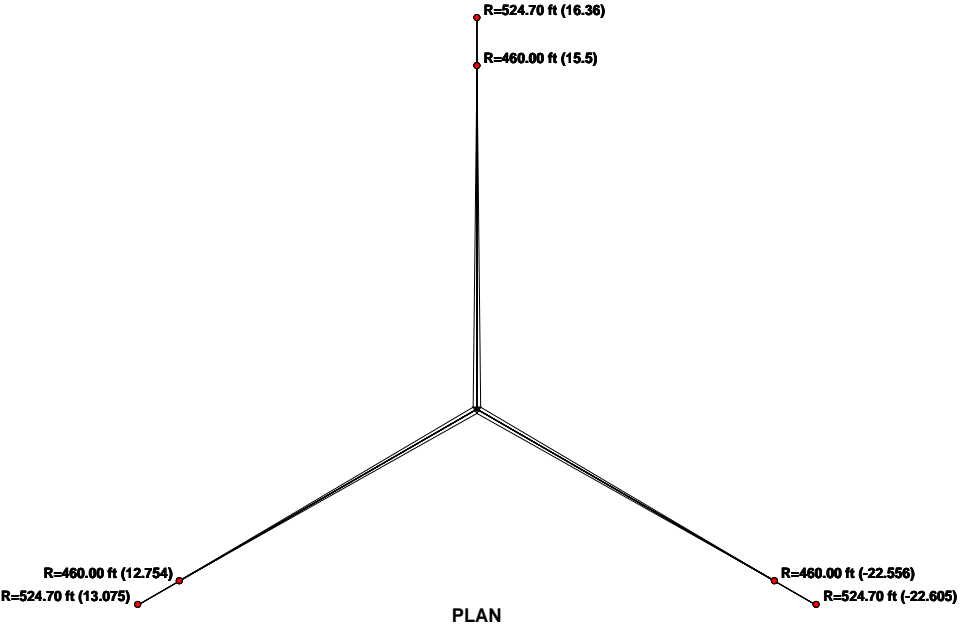
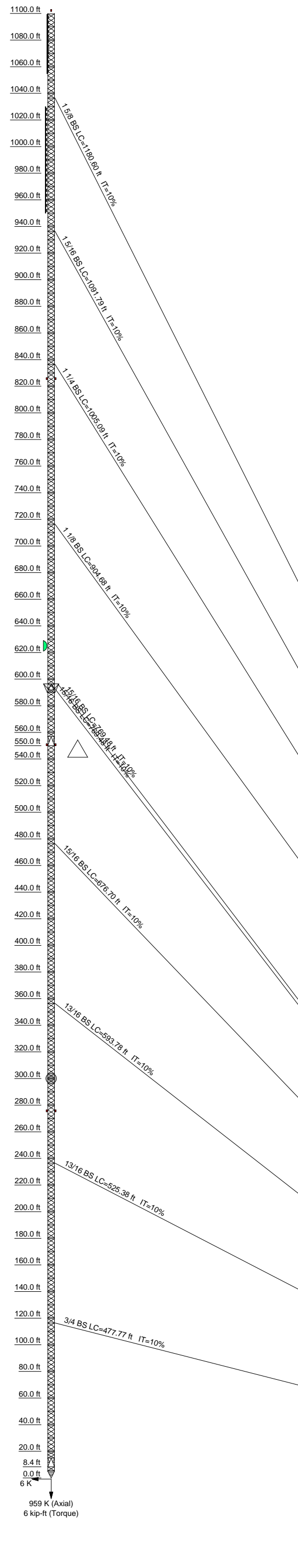

**DESIGNED APPURTENANCE LOADING**

TYPE	ELEVATION	TYPE	ELEVATION
up to 4' lightning rod	1102	8 FT DISH	625
Flash Beacon Lighting	1101.5	(2) Flash Beacon Lighting	550
TFU-28DSC S200	1099.3 - 1054.7	(2) Flash Beacon Lighting	550
10-Bay FM Antenna	1030 - 950	8 FT DISH	300
(2) Flash Beacon Lighting	825	(2) Flash Beacon Lighting	275
(2) Flash Beacon Lighting	825	(2) Flash Beacon Lighting	275

**SYMBOL LIST**

MARK	SIZE	MARK	SIZE
A	SR 4 1/2	K	1 @ 2.8
B	SR 1 1/8	L	1 @ 6.825
C	L2 1/2x2 1/2x3/8	M	1 @ 3.21833
D	SR 7/8	N	1 @ 3.20833
E	N.A.	O	1 @ 3.19833
F	4x1 9/16	P	1 @ 2.32167
G	MC12x35	Q	1 @ 2.37417
H	C12x25	R	1 @ 6.55417
I	SR 1 1/4	S	1 @ 3
J	SR 1 1/2	T	5 @ 1.08333

**MATERIAL STRENGTH**

GRADE	Fy	Fu	GRADE	Fy	Fu
A572-50	50 ksi	65 ksi	A36	36 ksi	58 ksi

**TOWER DESIGN NOTES**

1. Tower is located in Escambia County, Alabama.
2. Tower designed for a 100 mph basic wind in accordance with the TIA/EIA-222-F Standard.
3. Deflections are based upon a 50 mph wind.
4. Tower is designed with internal climbing ladder.

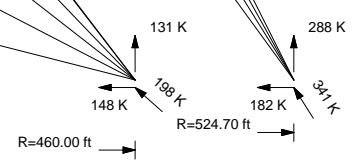

<p><b>Tower Innovations</b> 2855 Hwy. 261 Newburgh, IN. 47630 Phone: (812) 853-0595 FAX: (812) 853-6652</p>	<p>Job: <b>G2497 - 16248br8</b></p>
	<p>Project: <b>Bradley, AL.</b></p>
	<p>Client: _____ Drawn by: T.I. Engineering Dept. App'd: _____</p>
	<p>Code: TIA/EIA-222-F Date: 12/19/06 Scale: NTS</p>
<p>Path: _____ Dwg No. E-1</p>	